

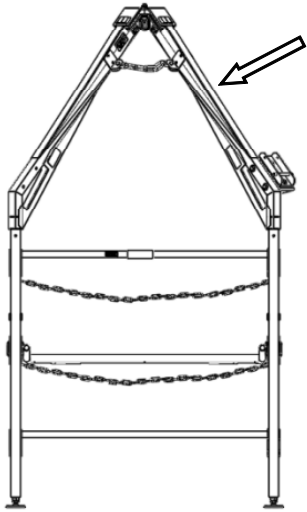

Installation Instructions

#MB-D5R - Alternate Pulley - LG5 System

Introduction: The T.A. Pelsue Company has developed an alternate fixed pulley system consisting of a formed bracket and pulley to be fitted on the LG5 system. The fixed pulley system is intended to be utilized in place of the hanging pulley & carabiner arrangement that is supplied as standard with LG5 systems. The #MB-D5R system has been specifically developed to be utilized when a DBI/SALA Model #L3503-1 SRL/Rescue device is used in conjunction with an LG5 system. The model #MB-D5R affords proper cable alignment when the Model #L3503-1 is installed within the Model LG5's standard winch mounting location (outside of front right side leg). The Pulley system will also install on the outside of the front right side leg of the upper assembly of the LG5 system. This document will provide installation steps.



1. The alternate pulley and bracket must be installed on the outside of the front right side leg of the upper section of the LG5 System for proper cable clearance.

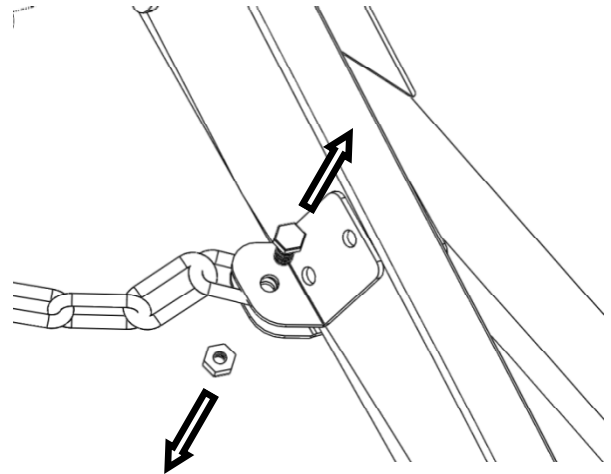

2. Remove the bolt and nut securing the restraint chain onto the front right side leg. A replacement bolt and nut are provided for re-installation.

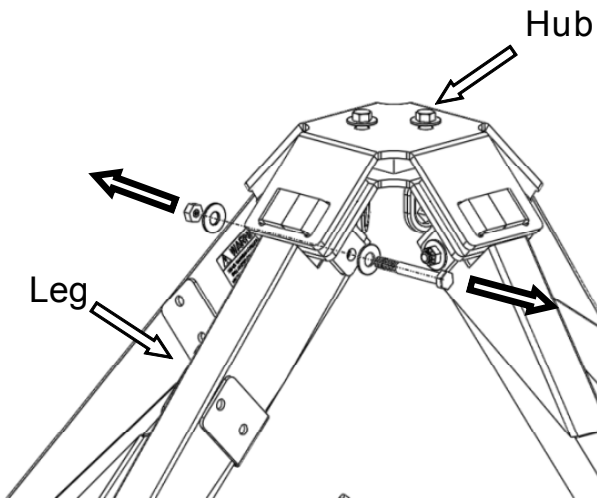

3. Remove the hardware securing the front right side leg onto the hub and remove the leg from the assembly.



2500 S. Tejon St.
 Englewood, CO 80110
 Ph: 1-800-525-8460, (303) 936-7432
 Fax: (303)934-5581
 Web: www.pelsue.com E-mail: sales@pelsue.com



4. The pulley bracket will be mounted to this leg after drilling. The following page will provide the required drilling locations and hole sizes. A full scale hole template has been provided, this template can be printed at full scale and placed on the leg to mark the drilling locations. Double check your marks according to the provided dimensions prior to any drilling!

HOLES PARALLEL
WITH BOTTOM OF TUBE

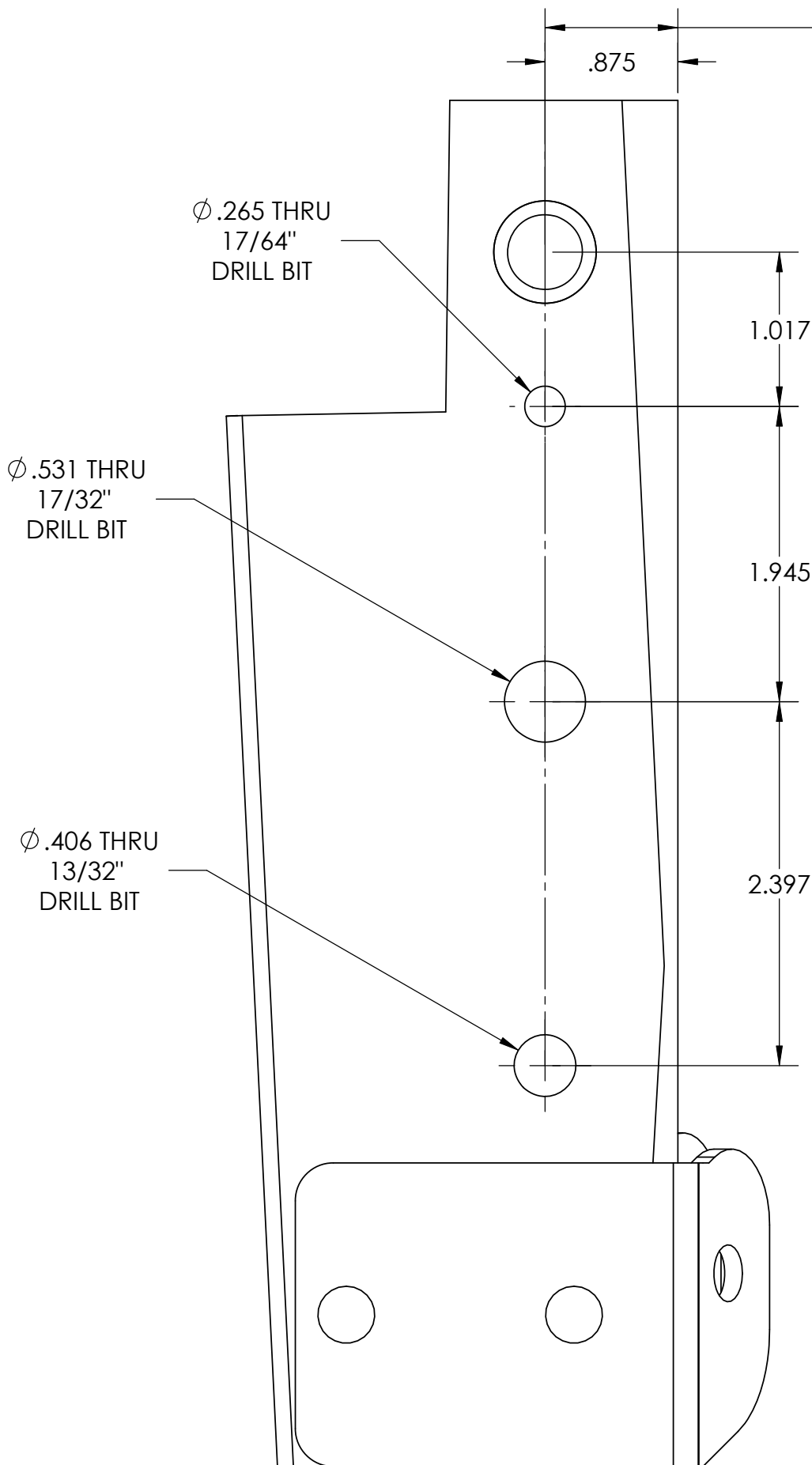

ALL HOLES BASED
OFF OF EXISTING
LEG MOUNTING HOLE

5. After drilling is complete, insert the leg back into the hub and secure all required hardware shown below.

LANYARD ATTACHED TO COTTER PIN (#7) MUST BE SECURED ON WITH MOUNTING BOLT #1 THROUGH LOOP

LANYARD ATTACHED TO PINS (#7 & #8) MUST BE SECURED ON WITH MOUNTING BOLT #1 THROUGH LOOP

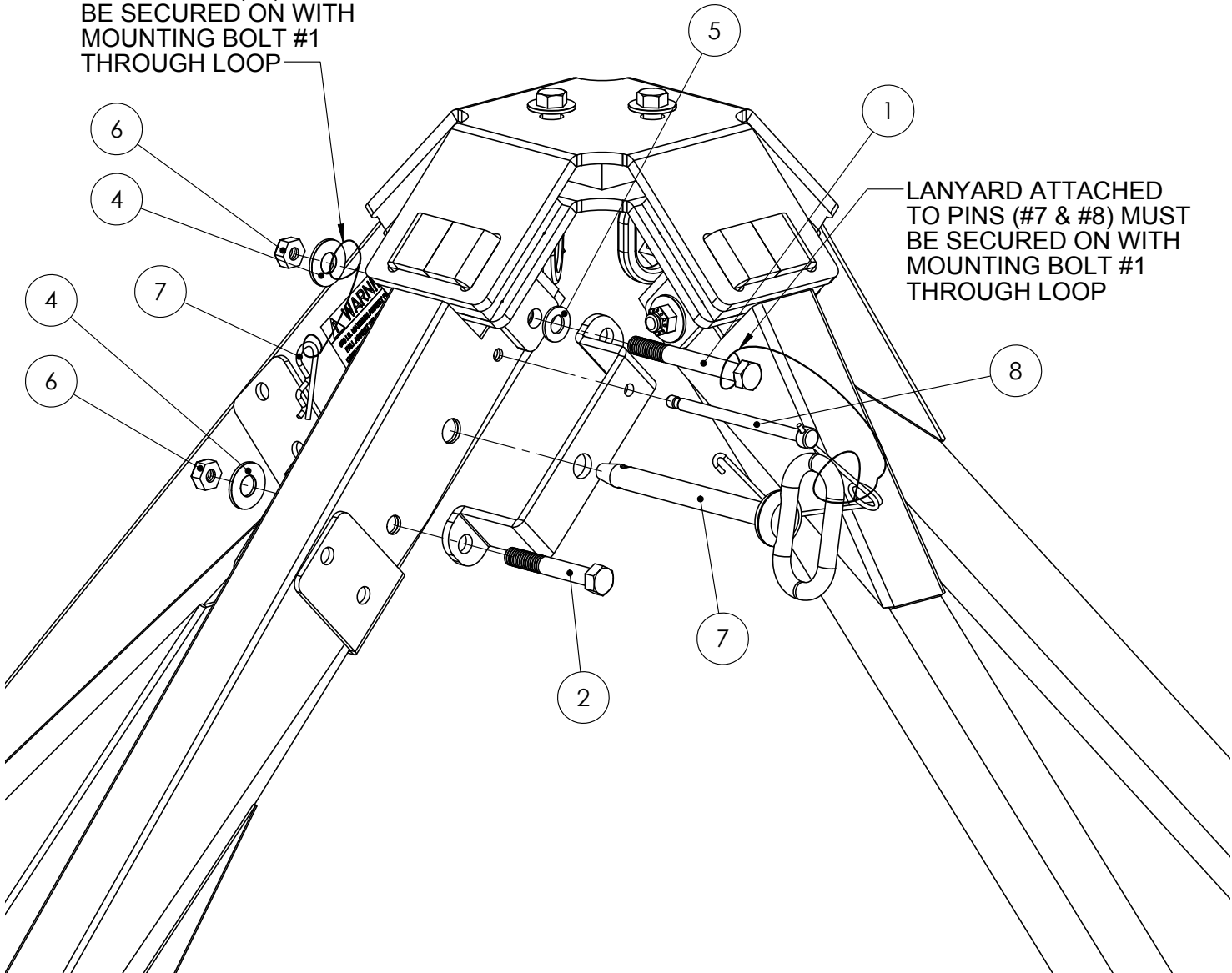

ITEM NO.	PART #	DESCRIPTION	QTY.
1	124021-325	SCREW - CAP, HEX, 3/8-16 X 3-1/4"	1
2	124021-250	SCREW - CAP, HEX, 3/8-16 X 2-1/2"	1
3	100163-008	SCREW - CAP, HEX, 3/8-16 X 1"	1
4	100050-011	WASHER - FLAT, 3/8"	2
5	123988-001	WASHER - FLAT, NYLON, 3/8"	1
6	107943-001	NUT - STOVER, 3/8-16	3
7	120605-001	PIN - HITCH, 1/2" DIA X 4-1/4"	1
8	501100-001	PIN - LOCKING, 1/4" DIA X 3-1/2"	1
9	501114-001	ASSEMBLY - SPACER & SHEAVE	1

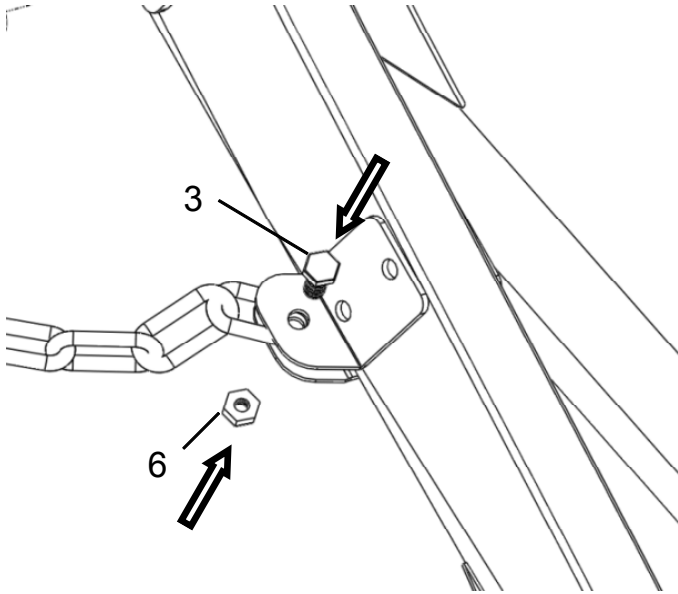

6. After the leg is mounted back onto the hub, re-install the restraint chain with the provided hardware.

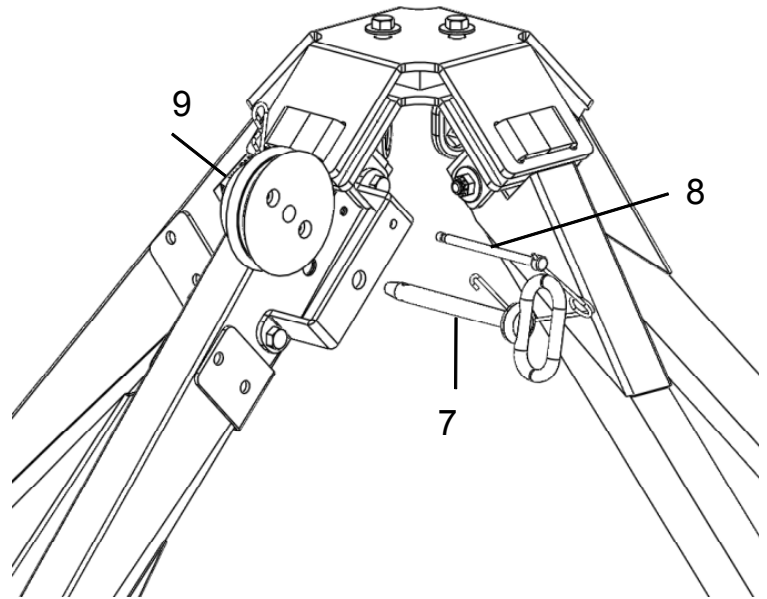

7. To install the pulley (#9), remove pins #7 & #8. Slide the cable hook between the leg and the bracket from the top then place the cable into the pulley's (#9) cable groove. Insert the pulley between the leg and the bracket from the bottom and insert the hitch pin (#7) through the bracket, pulley, and leg. The locking pin #8 is used to prevent the cable from coming off of the sheave during use. ! It is imperative that the winch cable be secured within the pulley groove with the cable pin (#8) at all times while employing the system!

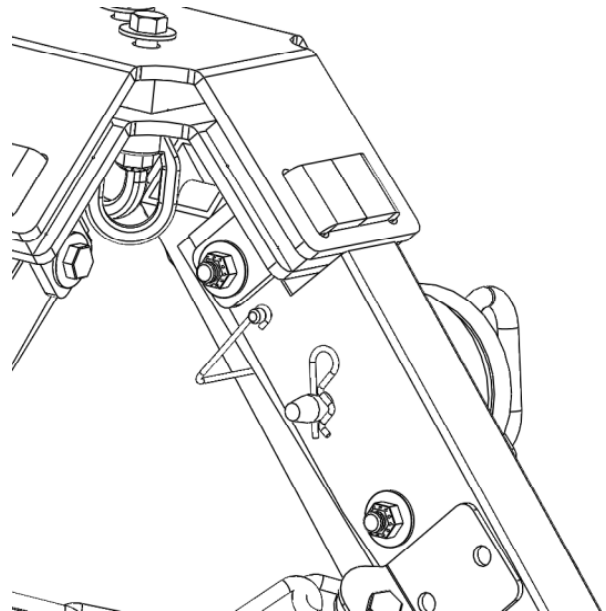
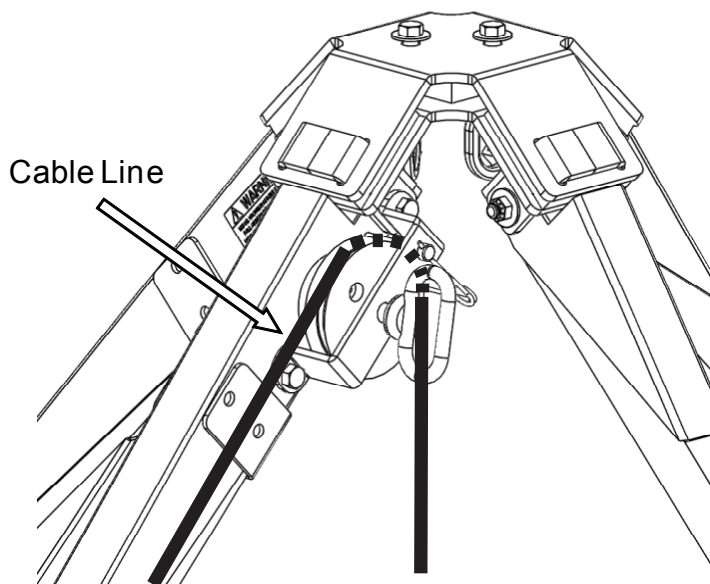

8. Ensure the locking bale of item #8 rests within the groove of the pin. Also ensure that the locking cotter pin of item #7 is installed and secure prior to any loading of the pulley.